



# AQUALEX FINE TOUCHPAD HOT

This manual contains details about the design, installation, usage and maintenance of your AQUALEX system.

We are constantly checking and revising our products and documentation. As a result, there may be minor changes to the technical manual over time. You can always find the most recent version on our website: [www.aqualex.eu](http://www.aqualex.eu)

If, after reading the manual, you still have questions, the AQUALEX customer service will be happy to help you. Please email [service@aqualex.eu](mailto:service@aqualex.eu).

Keep this manual in a safe place.

---

## CONTENTS – TECHNICAL MANUAL

2	<b>Foreword</b>	
3	<b>Product information</b>	Overview of your AQUALEX system. Includes parts list, technical drawings and technical information about your tap, cooler, boiler, CO <sub>2</sub> flask and filter.
12	<b>Preparations for installation</b>	An overview of everything that needs to be in place, including ventilation, holes ready in the worktop and the space you will need for installation.
15	<b>Usage and maintenance</b>	Using and maintaining your AQUALEX system. Additional information about replacing your CO <sub>2</sub> cylinder.
20	<b>FAQ</b>	Frequently asked questions and answers.
22	<b>Terms and conditions</b>	

# OVERVIEW OF THE SYSTEM

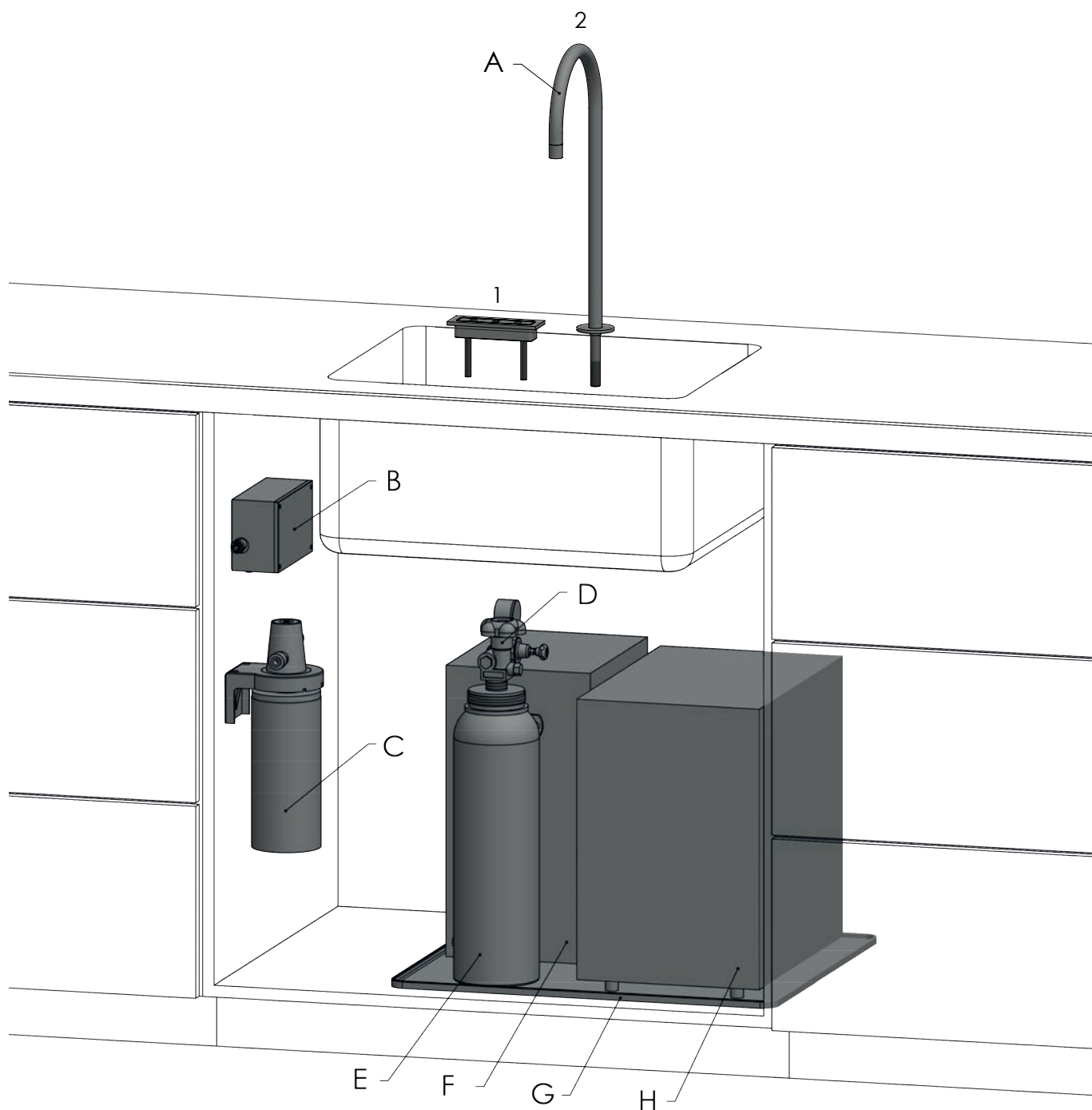

Your configuration may differ from the image.  
Some components are optional.

A) Fine Touchpad  
1 - Touchpad  
2 - Tap

B) Valve set  
C) Filter

D) Pressure regulator  
E) CO<sub>2</sub>-flask  
F) Boiler  
G) Flex mat L  
H) Cooler

# TAP AQUALEX FINE TOUCHPAD CHWG

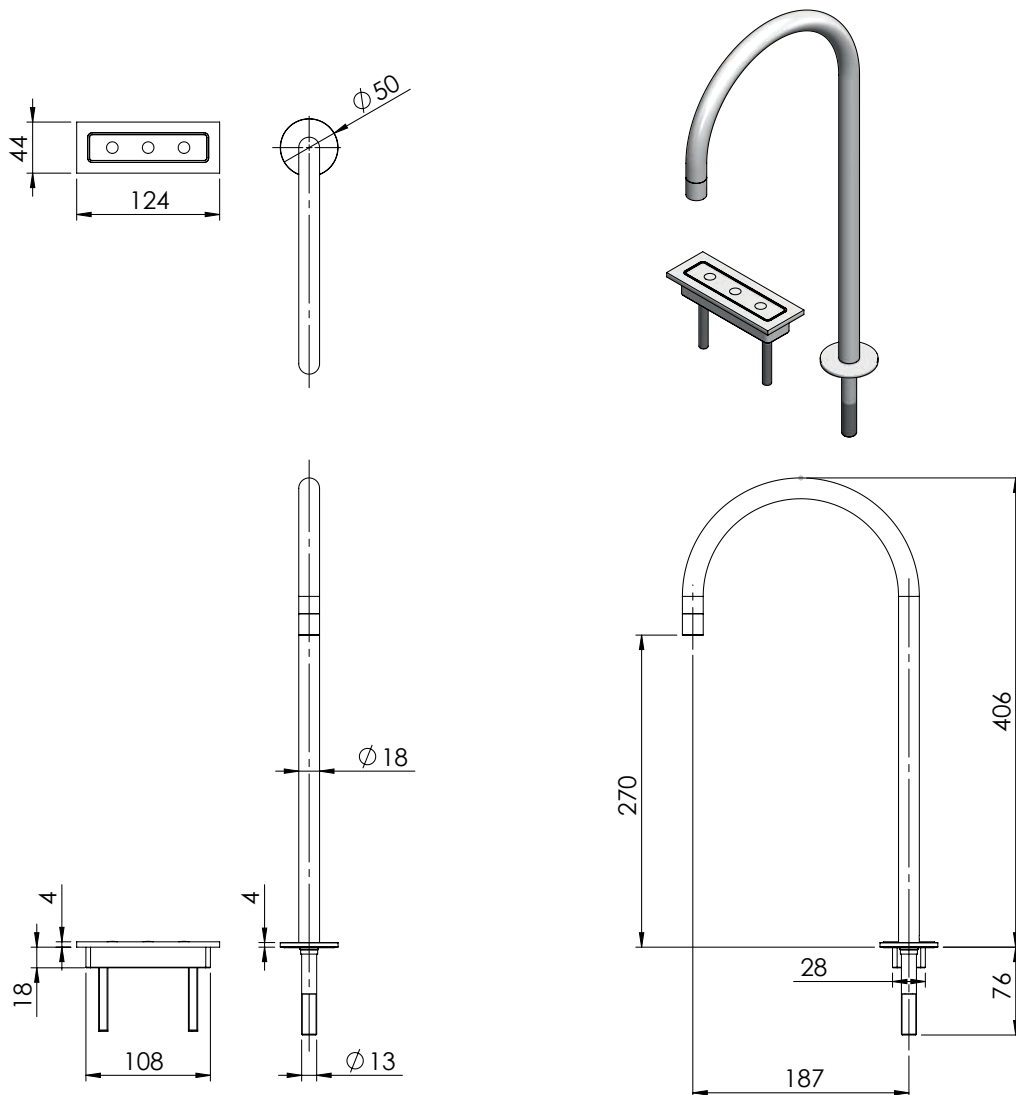

All dimensions in mm

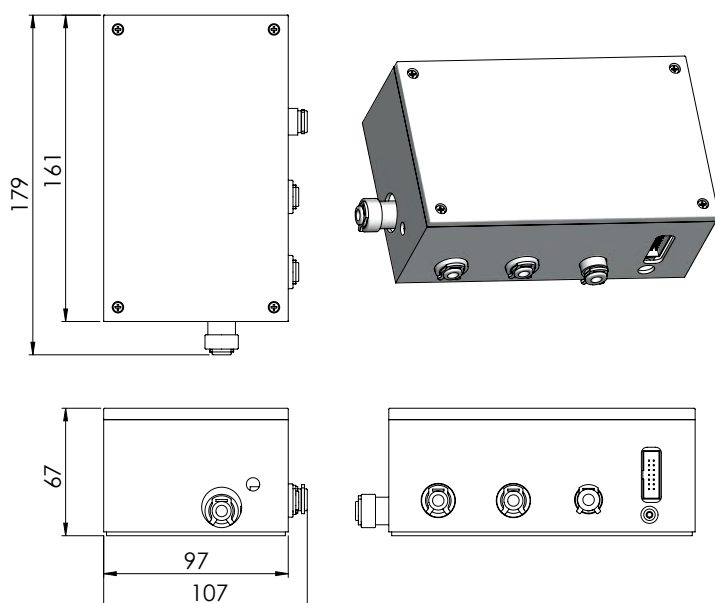

## Technical information

### Connections required:

- 1x COLD 3/4" double service valve with check valve
- 1x socket 230 V 50 Hz

### Water pressure IN

2,5 - 4 bar

# TAP AQUALEX FINE TOUCHPAD CHWG

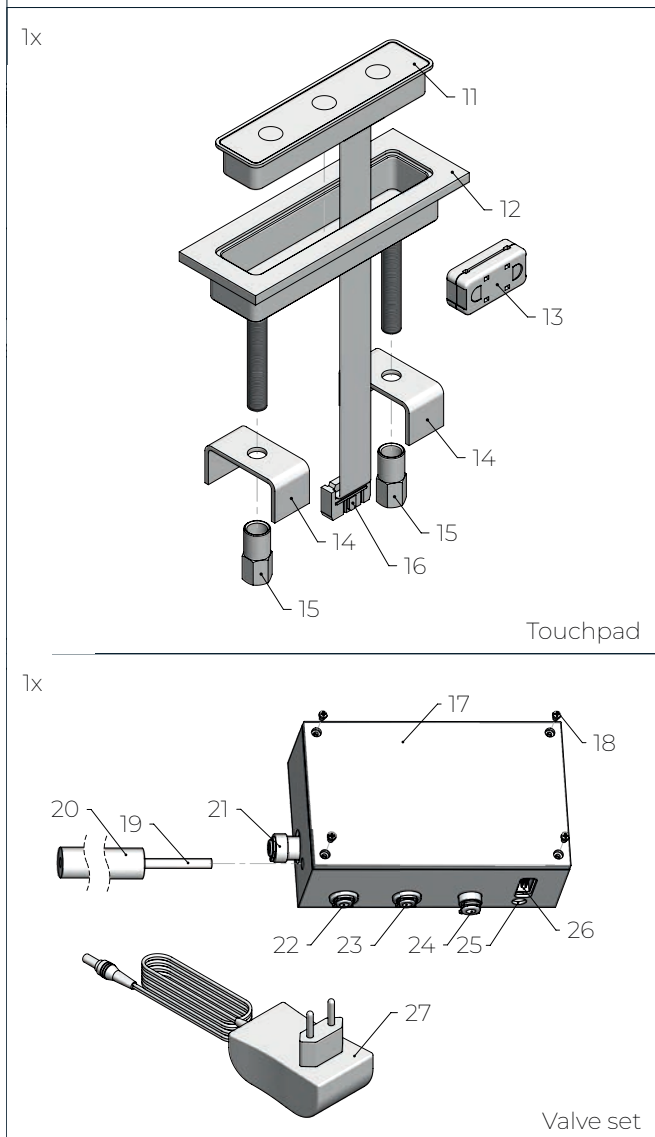
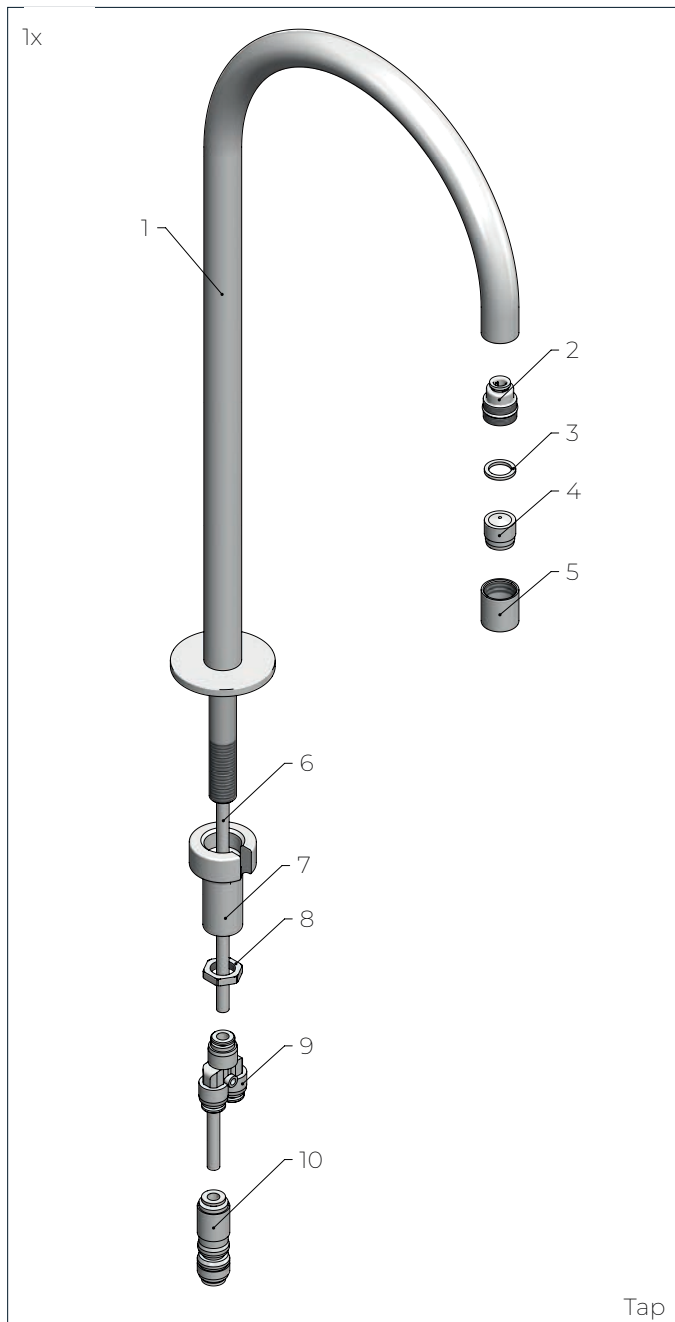

- 1 Tap neck
- 2 Tap strainer
- 3 O-ring
- 4 Jet controller
- 5 Tap strainer housing
- 6 Filtered water - IN
- 7 Stabilization plate
- 8 Tap nut
- 9 Y-piece
- 10 Check valve

- 11 Touchpad
- 12 Touchpad holder
- 13 Ferrite clamp
- 14 U-profile (2x)
- 15 Long nut (2x)
- 16 Valve set connector
- 17 Valve set housing
- 18 M3 screw (4x)
- 19 Filtered hot water - OUT

- 20 Piping insulation
- 21 Filtered water- UIT
- 22 Filtered cold water - OUT
- 23 Filtered sparkling water - IN
- 24 Filtered hot water - IN
- 25 Power - IN
- 26 Touchpad connector
- 27 Power cable for valve set

COOLER AQUALEX

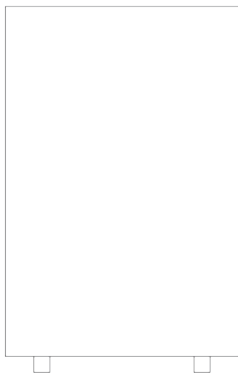
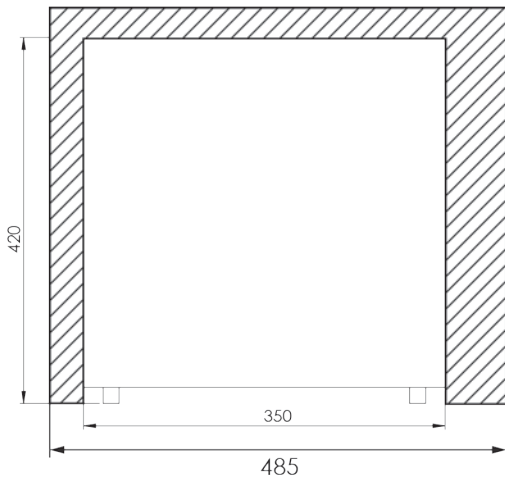
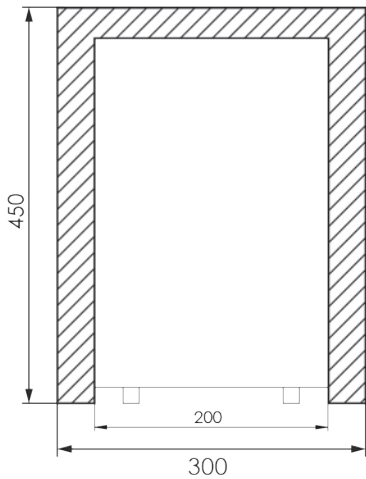
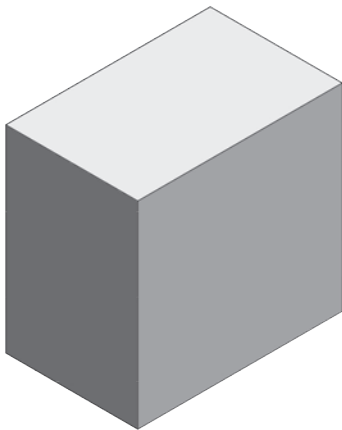
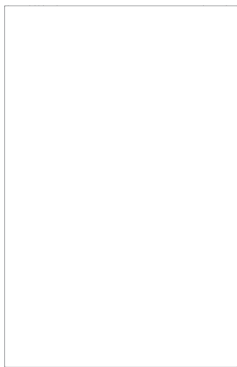

 = Minimum installation dimensions (free space)

Technical information

Installation dimensions LxWxH	485 x 300 x 450 mm
Product dimensions LxWxH	350 x 200 x 420 mm
Net weight	21 kg
Refrigerant	R290

Water pressure IN	2,5 - 4 bar
CO <sub>2</sub> - pressure IN	4 bar
Water temperature IN	5 - 20 °C
Water temperature OUT	3 - 10 °C

\*Cooled water varies 4-10 °C

# BOILER AQUALEX BOILER EVO

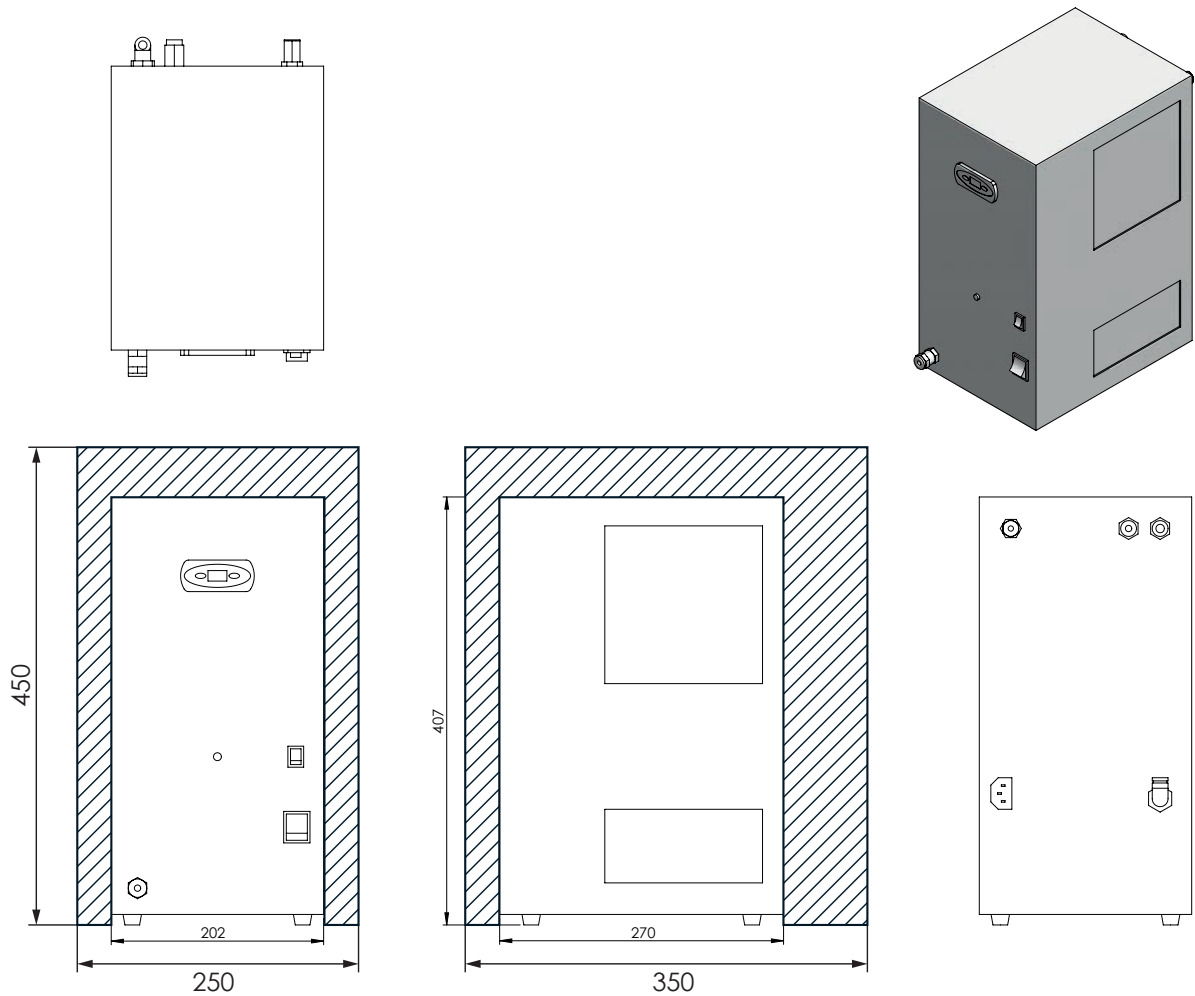

 = Minimum installation dimensions (free space)

## Technical information

Installation dimensions LxWxH	350 x 250 x 450 mm	Water pressure IN	2,5 - 4 bar
Product dimensions LxWxH	270 x 202 x 407 mm	Water temperature IN	5 - 20 °C
Voltage supply	1x 230 V - 50 Hz	Water temperature OUT	80 - 97 °C
Max. load	7,8 A		
Power	1800 W	CAPACITY (Incoming water 14 °C)	
Max. volume	45 dBa	Per hour	18 L
Net weight	12 kg	Continuous flow	3 L

# BOILER AQUALEX BOILER EVO

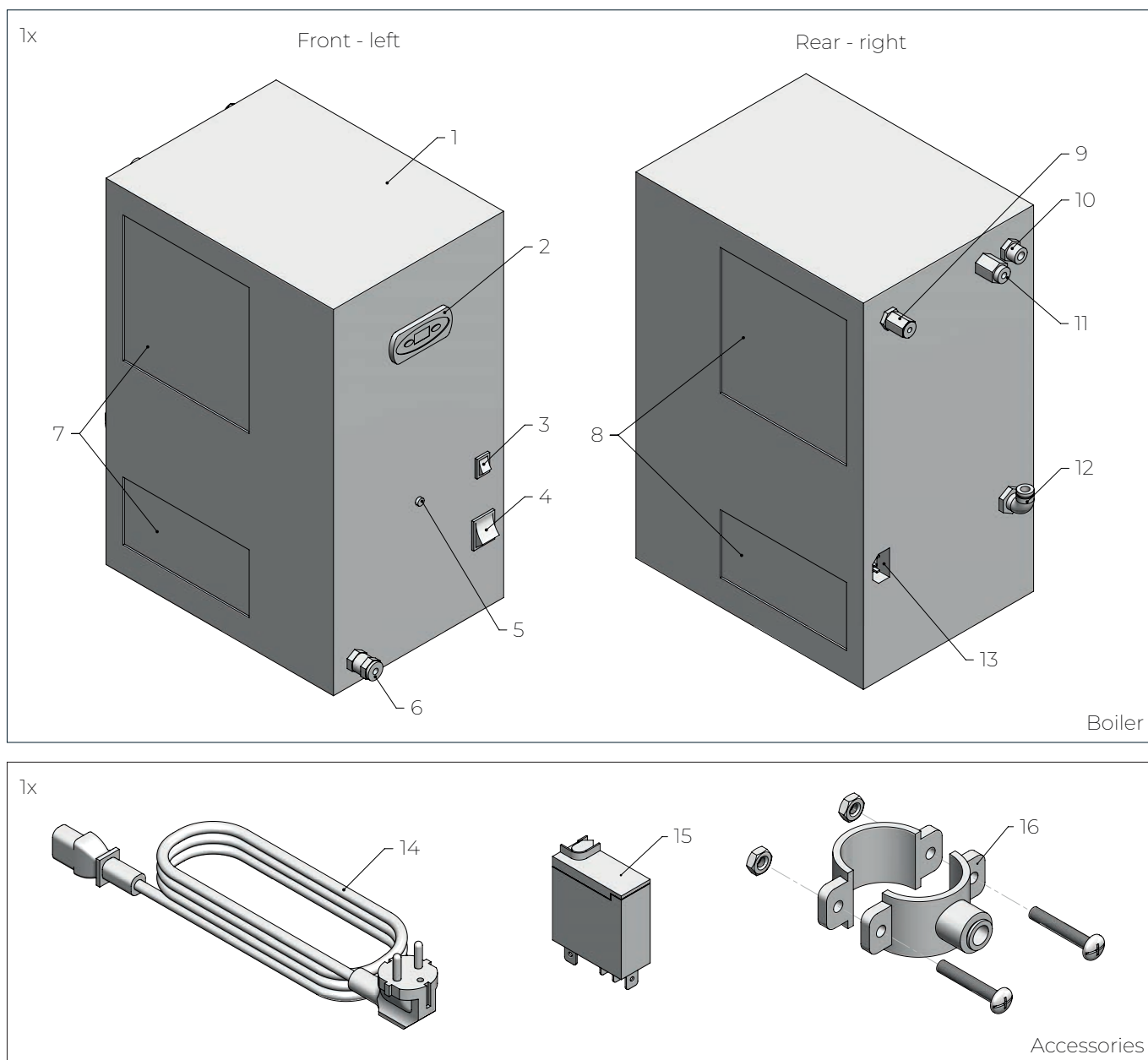

- 1 Housing
- 2 Display & settings knobs
- 3 Heating ON/OFF
- 4 General ON/OFF
- 5 Indicator lamp: abnormal fill
- 6 Service – OUT
- 7 Ventilation left
- 8 Ventilation right

- 9 Valve set connector
- 10 Waste – OUT
- 11 Filtered hot water – OUT
- 12 Filtered water – IN
- 13 Power – IN
- 14 Power cable for boiler
- 15 Relay for valve set
- 16 Waste pipe coupling



CO<sub>2</sub> 2 kg

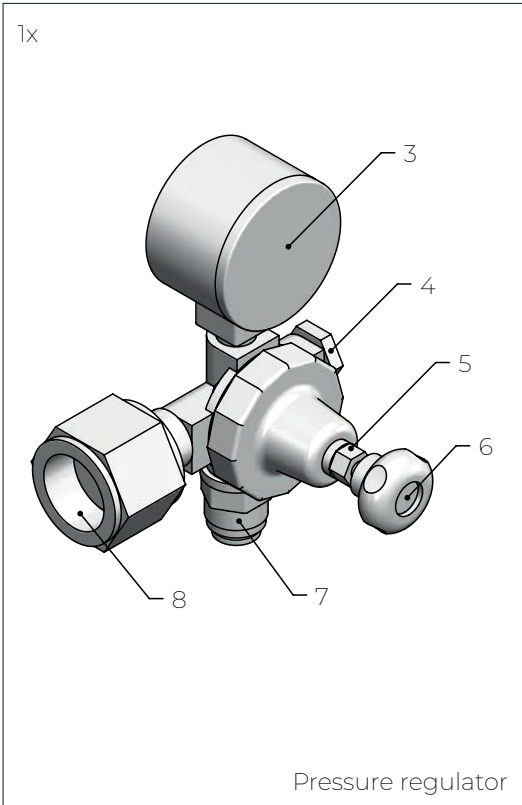
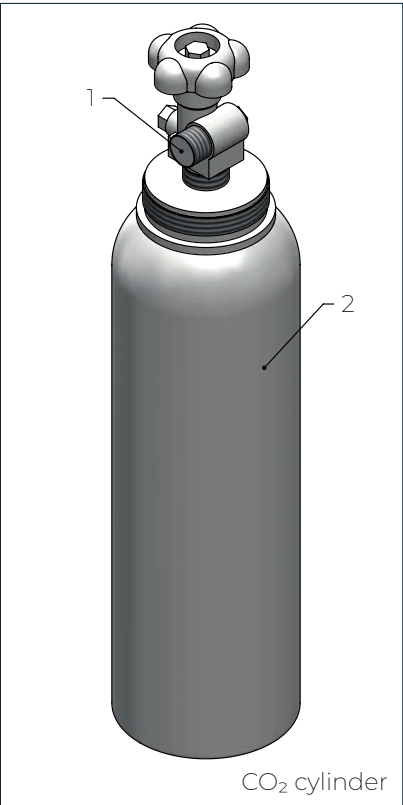

- 1 Pressure regulator connector
- 2 CO<sub>2</sub> cylinder 2 kg
- 3 Display
- 4 Overpressure valve
- 5 Regulator nut
- 6 Control knob
- 7 CO<sub>2</sub> – OUT
- 8 Connection CO<sub>2</sub> cylinder

All dimensions in mm

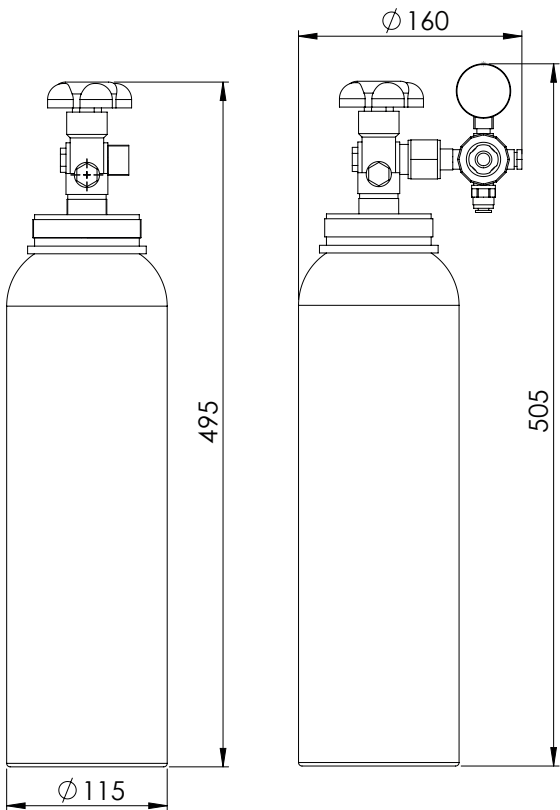

Technical information

CO <sub>2</sub> cylinder dimensions	Ø 115, h 495 mm
CO <sub>2</sub> cylinder + pressure regulator dimensions	Ø 160, h 505 mm
Weight CO <sub>2</sub>	2 kg
Litres of sparkling water	approx. 330
Gross weight	approx. 6,5 kg
Refillable	Yes
Max. ambient temperature	50 °C

The CO<sub>2</sub> cylinder must be kept upright at all times!  
Do not put the cylinder next to a heat source!

Storing CO<sub>2</sub> cylinders while not in use:  
ideally, keep them in a separate room  
(and not near your cooler or boiler).

# FILTER CLARIS ULTRA

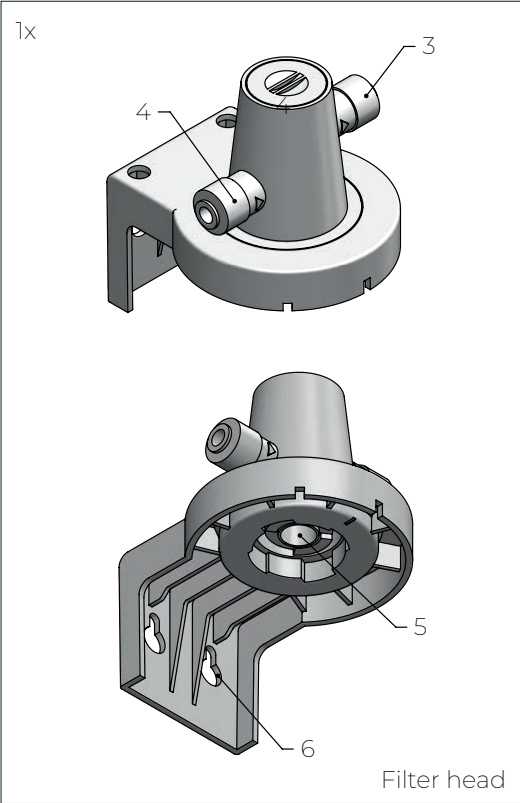
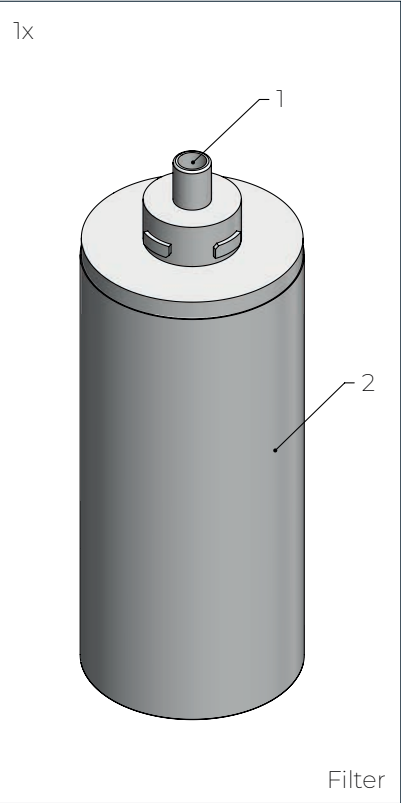

- 1 Filter head connection
- 2 Claris Ultra filter
- 3 Water – OUT
- 4 Water – IN
- 5 Filter connection
- 6 Wall mount

All dimensions in mm

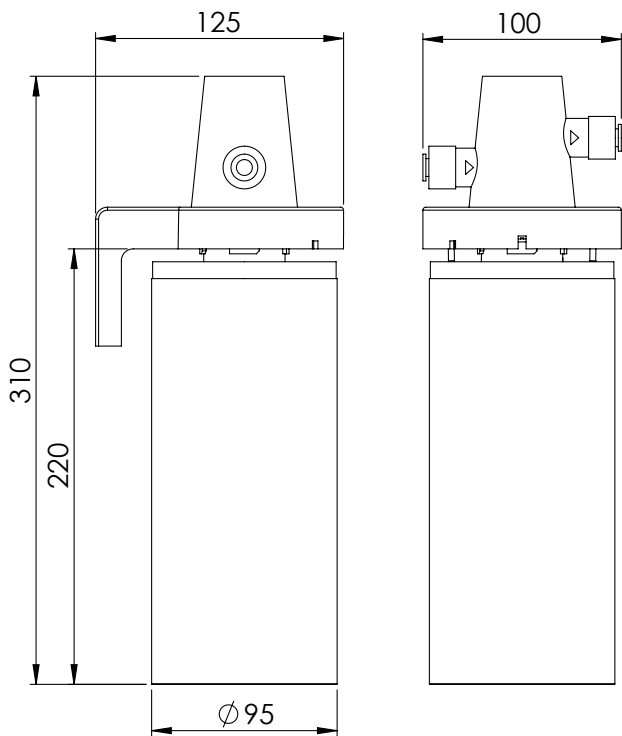

## Technical information

- Removes undesirable odours and flavours
- Filtration of all substances > 5 micron
- Guards against scale
- Removes heavy metals

Filter dimensions Ø 95, h 250 mm  
Filter + filter head dimensions (LxWxH) 125 x 100 x 310

Leave a 7 cm gap beneath the filter for replacing the filter.

Filtration	up to 5 micron
Filter capacity	1700 L
Max. flow rate	1.9 L/min
Water pressure required	2–8 bar
Water temperature	4–30 °C
NSF approved	Yes

# OVERVIEW OF PREPARATIONS

What you need to have in place before installation of the AQUALEX system.

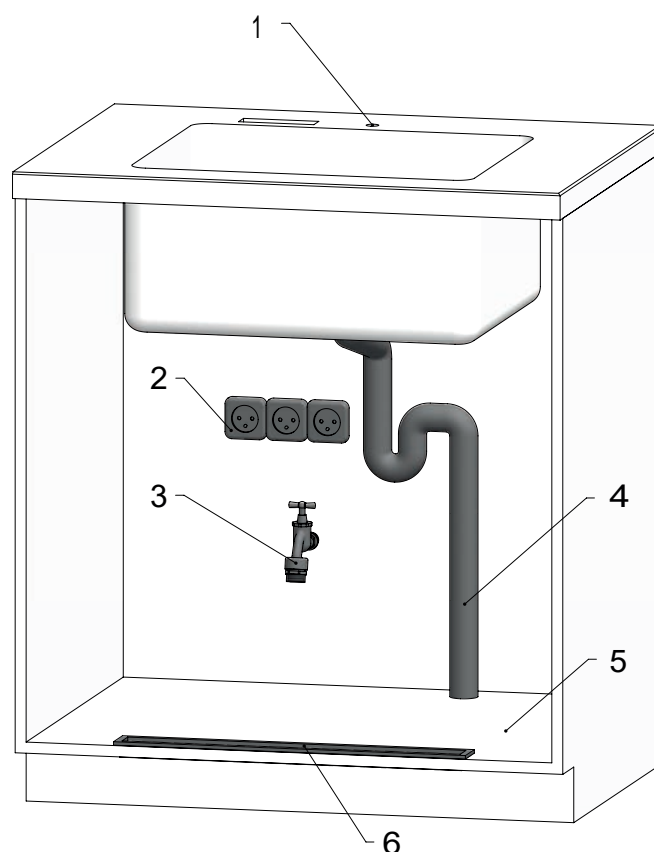

## 1 - Tap installation

Which holes do you need to make before installation if the tap? See **page 12** for more information.

## 2 - Electricity

- 1 x 230 V - 50 Hz socket for installation of the tap.
- 1 x 230 V - 50 Hz socket for installation of the cooler.

## 3 - Water connections

- 1x COLD EA 3/4" double servicetap with check valve

## 4 - Drainage

## 5 - Free installation space

Free space required for installation. See **page 13** for more information.

## 6 - Ventilation

Leave 2 openings of at least 200 cm<sup>2</sup> to provide natural ventilation.

This is important to ensure your appliances have a good service life. See **page 14** for more information.

# INSTALLING YOUR TAP

All dimensions in mm

You will need installation holes as follows:

- 1x  $\varnothing 18$  mm for tap
- 1x square opening 110 x 30 mm for the touchpad (no rounded corners!)

*Guidelines for positioning the holes:*

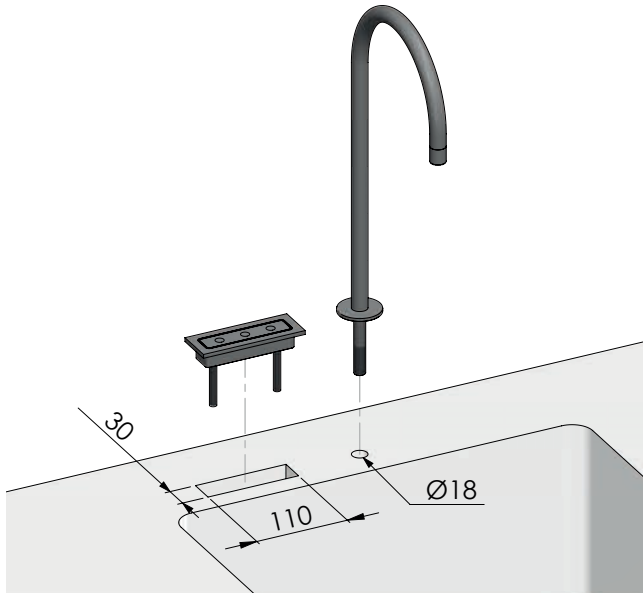

The standard AQUALEX installation template has the following dimensions:

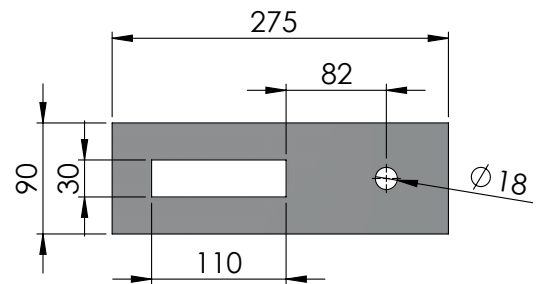

The touchpad location can be selected freely; optionally, it can be installed to the side of the sink.

Maximum depth of the worktop = 50 mm

Free space you will need around your tap:

- Make sure there is room above and below your worktop so that you can easily install and use the tap.

*How much free space should you leave? Guideline:*

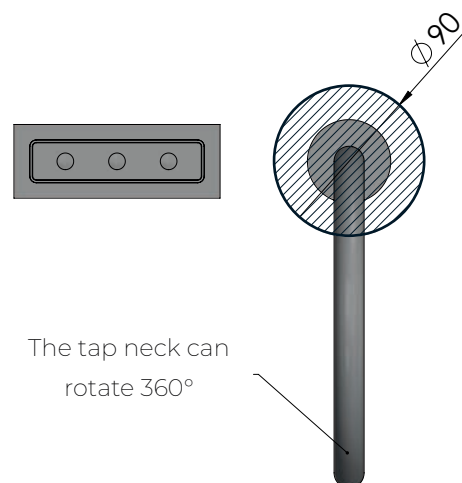
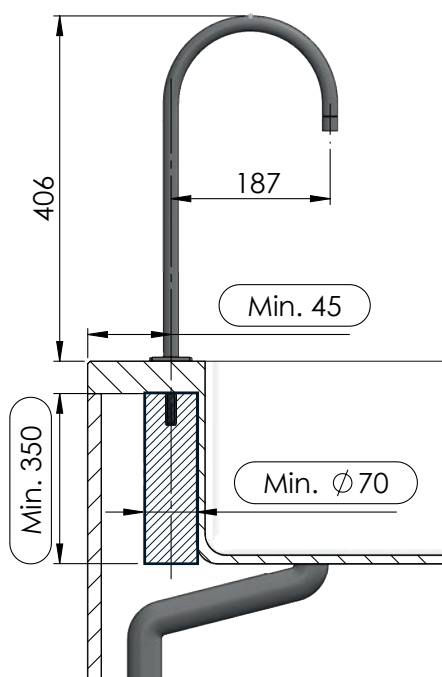

The tap neck can rotate 360°

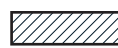
 = Extra free space needed for installation or use

# FREE INSTALLATION SPACE

There must be adequate space in the kitchen cabinet for the AQUALEX installation.

The minimum length, width and height are determined by the dimensions of the appliances, the filter and the CO<sub>2</sub> flask, plus extra space for pipes and ventilation. The *Flex mat L* indicates the free floor space needed for the system. It is important that existing supply and waste pipes are not in the way!

*The image below indicates the minimum amount of space that must be available:*

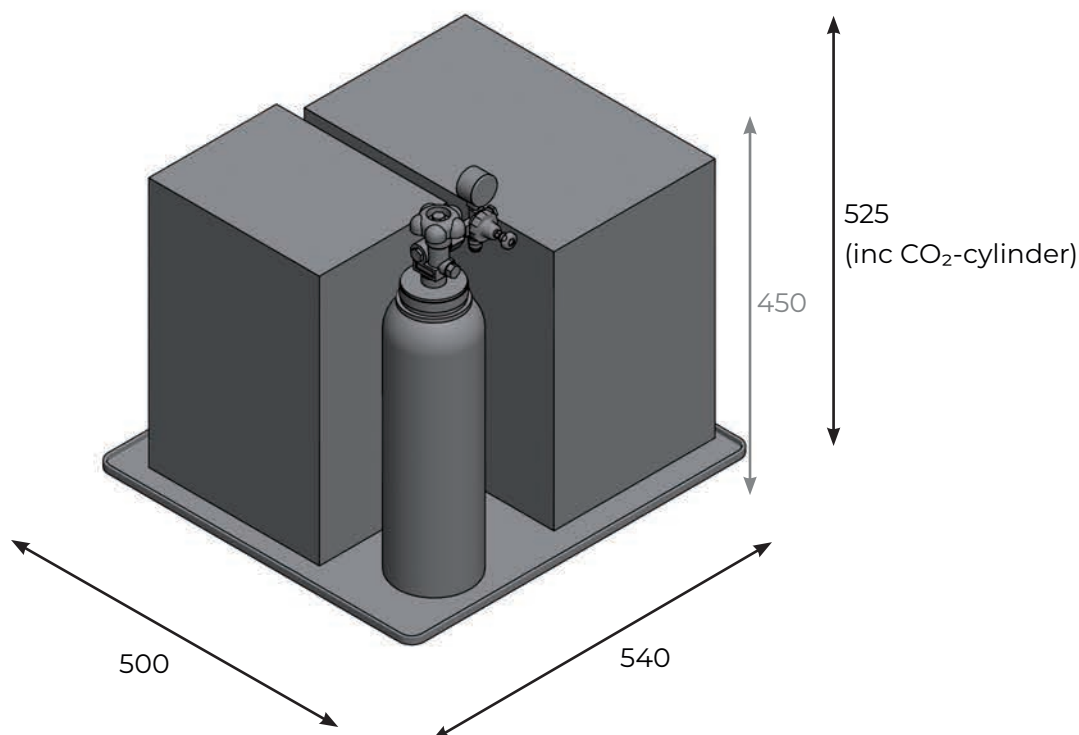

Make sure there is extra space behind the installation for waste and supply pipes, including the ones you currently have installed! Leave extra space for the ventilation openings and any valve sets you need.

All dimensions in mm

## Afstand kleppenset

De lengte van de kabel voor verbinding van de touchpad met de kleppenset is 1 m.  
Hou hiermee rekening bij het plaatsen!

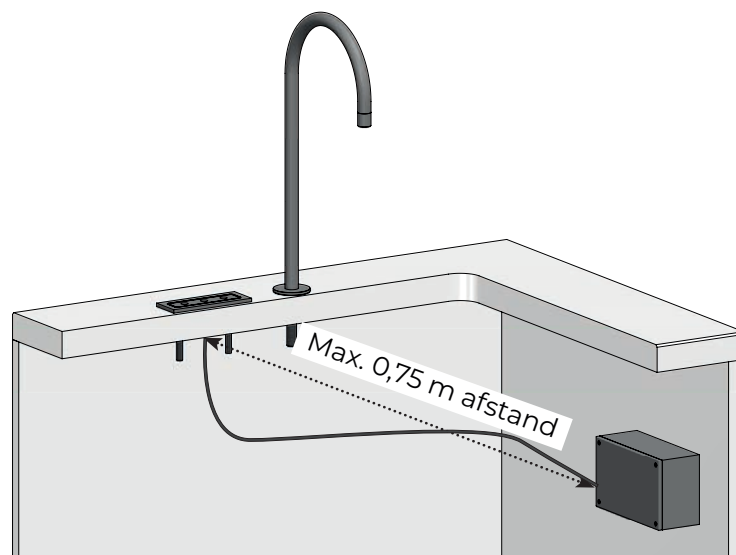

# VENTILATION

It is important that your appliances have adequate ventilation for cooling.

By letting fresh air in at the bottom of the cabinet and letting it out at the top, it creates natural ventilation:

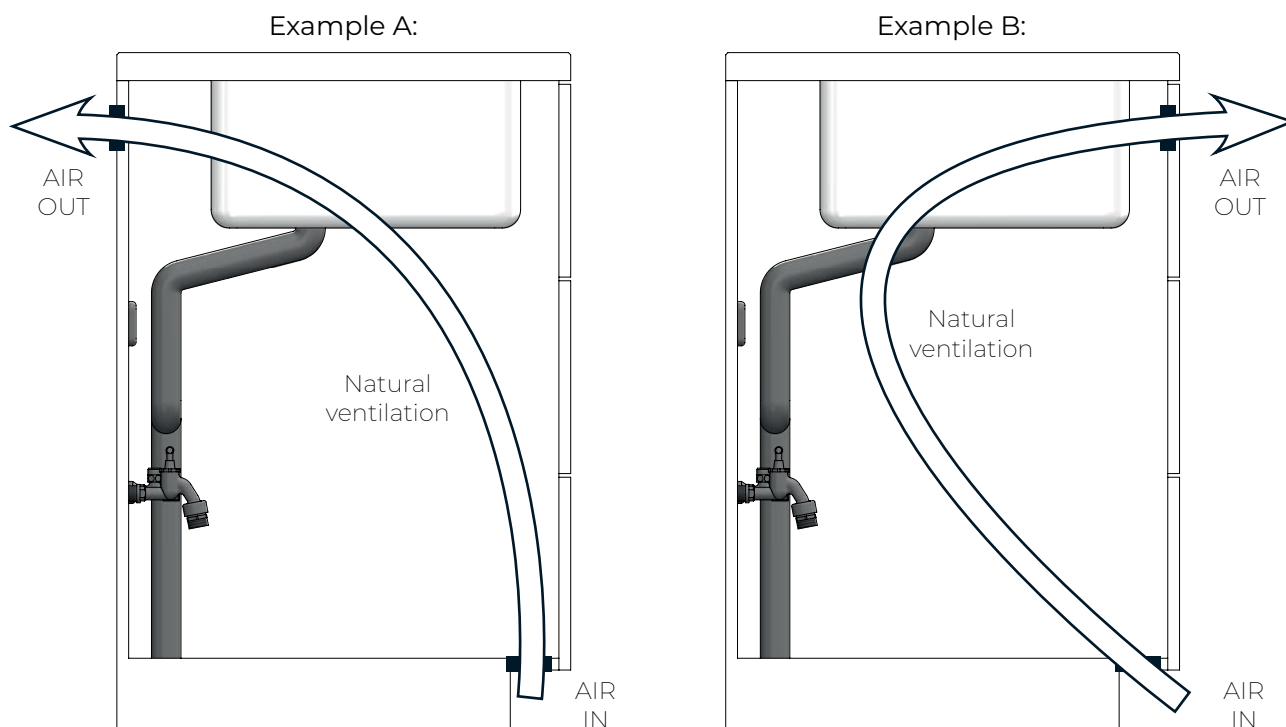

Make sure there is adequate natural ventilation by creating ventilation openings below and above the appliance.

!! CAUTION: without adequate ventilation, the installation can become overheated and your guarantee will be voided.

## Dimensions of the openings

All dimensions in mm

Both bottom and top openings of **at least 200 cm<sup>2</sup>** should be provided.

The shape and finish is free to choose.

*Example:*

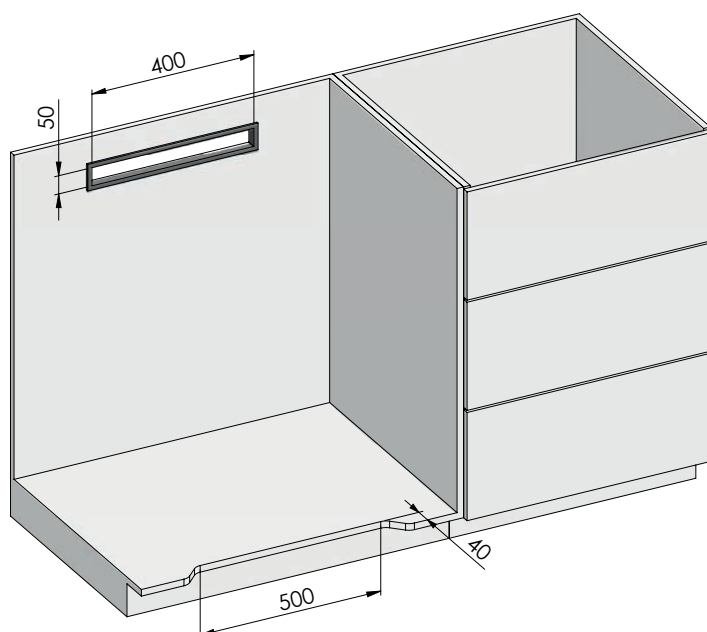

On our website you can view examples of installations with good ventilation:

[www.aqualex.eu/en/ventilation](http://www.aqualex.eu/en/ventilation)

# USAGE AQUALEX FINE TOUCHPAD CHWG

## Using the touchpad

For taking filtered water

- **Filtered cold and sparkling water:** pressing the buttons starts and stops the flow of water.  
=> Optionally, the buttons can be configured so that you need to press and hold for filtered water. Releasing the button stops the water flow.
- **Filtered hot water:** activating hot water is done by completing the following steps:
  1. Short push (0.5 s)
  2. Short release (0.5 s)
  3. keep pushing, after 2 sec the hot water flows as long as the button remains pushed.
  4. as soon as you release the button the hot water stops flowing.

!! CAUTION: NEVER PUT YOUR HAND UNDER HOT WATER !!!

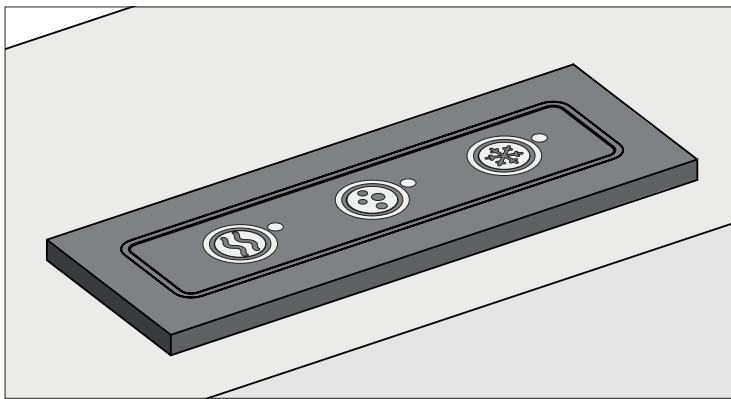

**Hot**  
Filtered hot water



**Sparkling**  
Filtered cold sparkling water



**Cold**  
Filtered cold water

# MAINTENANCE OF YOUR TAP

A kitchen tap is used every day. It is therefore very important to clean your tap work daily for long-lasting use.

## Maintenance of the tap

Dry the tap after each use to avoid limescale deposits.

It is best to clean the tap with a mild soap.

!! ATTENTION: Do not use scouring pads, abrasives, solvents, cleaning agents with acid, undiluted cleaning agents, anti-scaling agents and vinegar.  
These will irreversibly damage the surface of your tap.

## Maintenance of tap end

Dry the tap end after each use to avoid limescale deposits. It is recommended - depending on the hardness of your water - to regularly clear the tap strainer (jet regulator) of limescale. This prevents blockages and splashing of the tap. Unscrew the tap strainer and place it, **without the sleeve**, in vinegar until the limescale is gone.

The tap strainer is located in the end of the tap. It causes air to be mixed with water.

By adding air, less water passes through the tap which saves water.

### *Descaling the tap strainer:*

- 1) Unscrew the sleeve manually and submerge the tap strainer (without sleeve or O-ring) in vinegar until the scale dissolves.
- 2) Leave the flow regulator to dry.
- 3) Turn the jet regulator back onto the tap neck.  
When doing so, keep into account the correct order of parts.
- 4) Flush 1 litre of cold water before tapping drinking water for optimum taste.

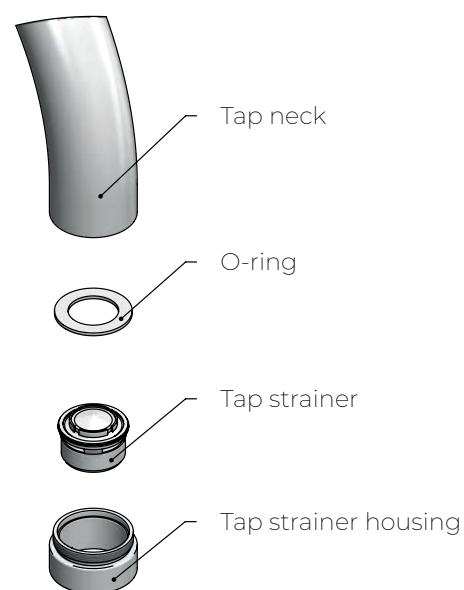

## Guarantee and service

Lime scale or limescale damage is not included in the warranty, including the maintenance contract. If you would like a new tap end or faucet, please place an order by e-mail at [service@aqualex.eu](mailto:service@aqualex.eu).

Prevent limescale by always drying the tap after use.

Lime is very aggressive and will damage the surface.



# USAGE AND MAINTENANCE OF THE COOLER

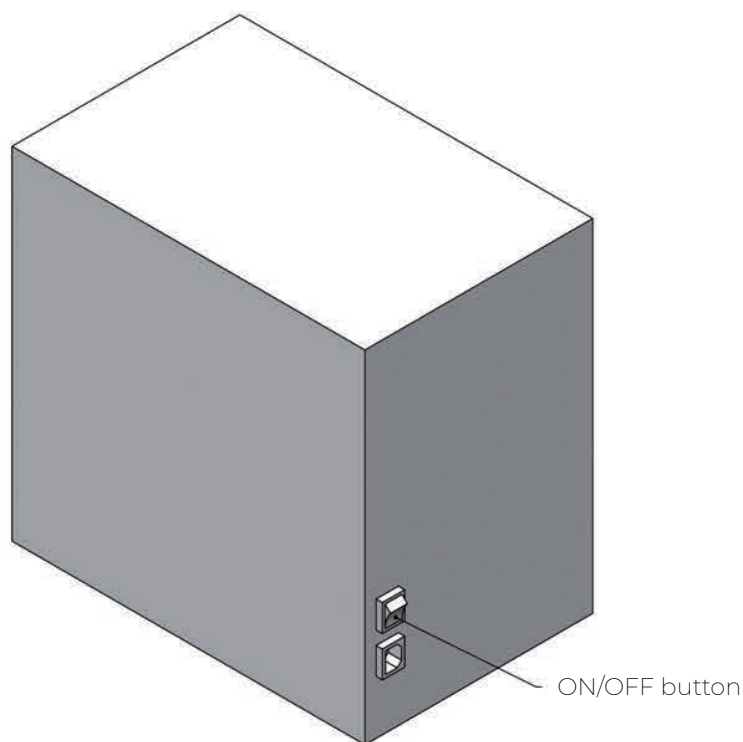

## Maintenance and tips for a long cooler life:

- Clean the cooler surface with a soft cloth. Use a small amount of water.  
Use liquid soap if necessary. Avoid contact with the electronic parts of the appliance.
- Install the cooler in a dry, dust-free location.
- Never subject the cooler to vibrations.
- Never put anything on top or leaning against the cooler.
- Make sure the ventilation openings on the cooler are kept dust-free. Inadequate ventilation will reduce the lifespan of your appliance.

## If there is a problem or defect:

First of all, check the **FAQ** in this manual. Most common questions are answered in the FAQ.

If you need further help, the AQUALEX customer service will be happy to help you.  
Please email [service@aqualex.eu](mailto:service@aqualex.eu).

We recommend unplugging the appliance during long periods of disuse (e.g. holidays), as this saves energy! When you turn the appliance back on, let a few litres of filtered water run through before using it for drinking water.

# USAGE AND MAINTENANCE OF THE BOILER

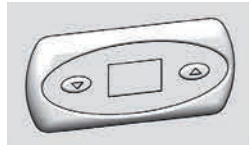
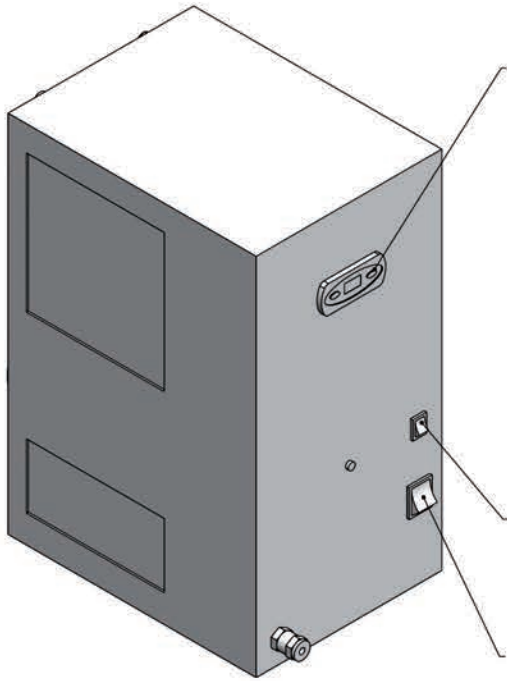

## Temperature display

Displays the current temperature of the water in the boiler.

If there is a dot after the temperature value, the water has not yet reached the configured temperature.

The boiler is heating.

## On/off button – heating

Stops water from heating. However, remaining hot water can still be used. If the red light is on, the water is heating up to the configured temperature.

## Main on/off button

Switches the boiler on or off.

## Maintenance and tips for a long boiler life:

- Clean the boiler surface with a soft cloth. Use a small amount of water. Use liquid soap if necessary. Avoid contact with the electronic parts of the appliance.
- Install the boiler in a dry, dust-free location and never expose it to vibrations.
- Do not plug additional appliances into the socket that you are using for the boiler.
- Never put anything on top of or leaning against the boiler.
- Ensure that the vents of the boiler remain dust-free. Inadequate ventilation will reduce the lifespan of your appliance.

## What to do in case of a problem or defect?

Please consult the **FAQ** in this manual first. There you will find the most common questions and answers. If you need further help, you can always contact us via email: [service@aqualex.eu](mailto:service@aqualex.eu)

We recommend unplugging the appliance during long periods of disuse (e.g. holidays), as this saves energy!

When using the appliance again, it is advisable to first run several litres of filtered water before drawing off drinking water.

# REPLACING THE REFILLABLE CO<sub>2</sub> CYLINDER

When should you replace it?

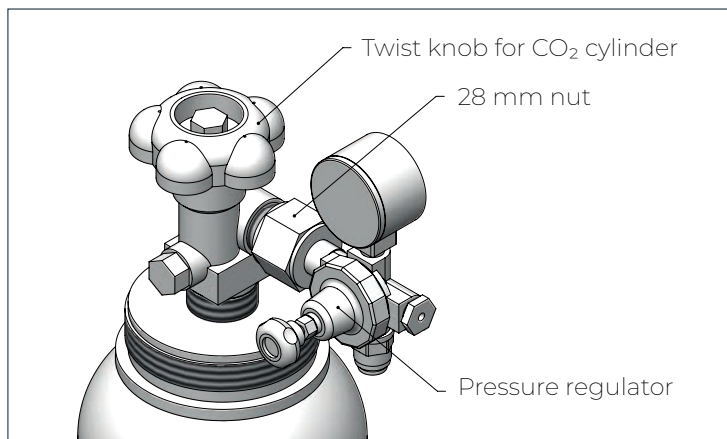

The pressure regulator controls the CO<sub>2</sub> pressure in the cooler. By default, the pressure is set to 4 bar.

If the pressure falls below 3.5 bar, this means the cylinder is empty. You will notice that the water is less bubbly. Don't wait for the pressure to drop further: replace the cylinder straight away.

Increasing the pressure above 4 bar will **not** make the water more bubbly, as one might suspect!

Replacing the cylinder:

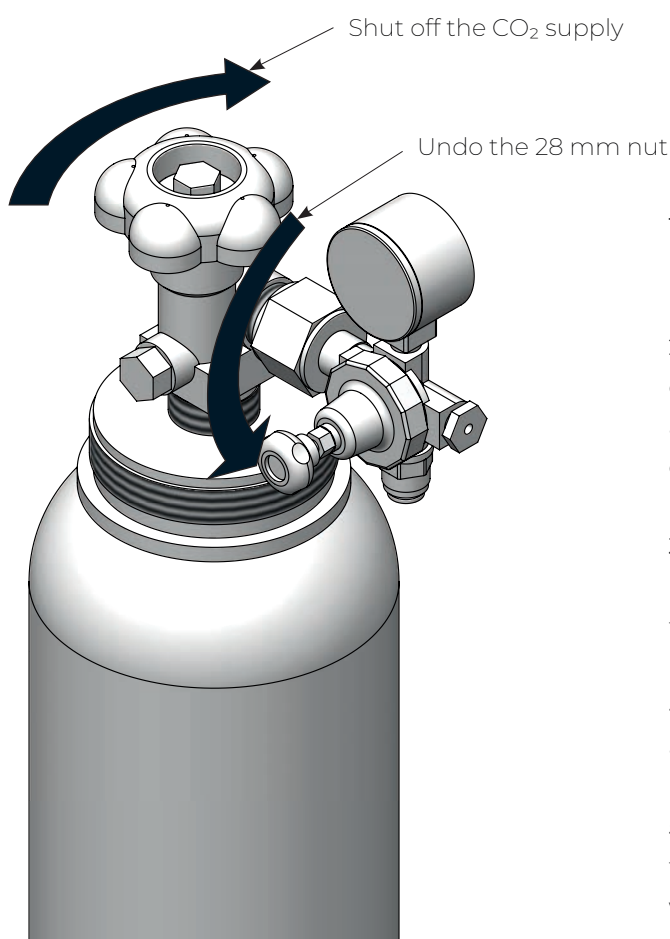

1) Turn the main knob on the CO<sub>2</sub> cylinder to closed, by turning it clockwise. This shuts off the CO<sub>2</sub> supply.

2) Use a 28 mm spanner to undo the nut between the cylinder and the pressure regulator, by turning it anticlockwise. Remove the pressure regulator from the cylinder.

3) Take the new CO<sub>2</sub> cylinder and screw the pressure regulator with the nut firmly onto the new cylinder, turning the nut clockwise.

4) Shut off the cylinder at the main knob, by turning it anticlockwise. Check that the pressure jumps to 4 bar.

5) After replacement, run a few litres of water through the system so that the CO<sub>2</sub> becomes saturated with the water.

In need of new CO<sub>2</sub> cylinders? You can request them on the **MyAQUALEX platform** or send an email to [info@aqualex.eu](mailto:info@aqualex.eu) with the desired number of cylinders, location of installation and any billing details. During annual maintenance, the technician will bring some new cylinders as standard.

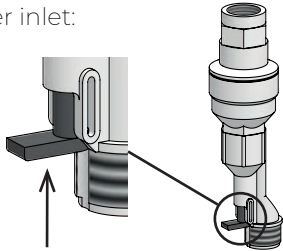
Problem	Cause	Solution
No water	Aquastop is active	<p>The aquastop is a safeguard against unwanted water loss. Check that you do not have a leak anywhere. If no leak is present, you can reset the aquastop by pressing the red button. This is located at the water inlet:</p> 
	No electricity to appliance	Check that the appliance is properly plugged in. If the appliance has an on/off button, check that it is switched on.
	Fault in appliance	Switch the appliance off and on again using the switch on the appliance. If there is no switch, unplug the appliance from the socket. This provides a general reset.
	Overheating	If the appliance or cabinet is very warm to the touch, the appliance may be overheated. Switch the appliance off, leave it for a while, and ventilate the cabinet. Plug it back in once you have identified the cause of the overheating.
Not enough water	Tap not fully open	Check that the water intake taps in your cabinet are turned on fully.
	Scale build up on flow regulator	Clean your tap strainer (see chapter 'Usage and maintenance').
	Water pressure too low	Low pressure on city water can ensure, in combination with a filter, that the water flow rate is too low. Compare the city water to another place in the house. If the pressure is too low there too, check the main tap and contact your water supply company.
No cooled water	Cooler not switched on	Make sure that the plug for the cooler is in a properly functioning socket.
	You have just drawn a large quantity of water	A cooler can only supply up to a maximum quantity of cooled water continuously. Wait for a short while until more cooled water is available.

The table continues on the next page.

No hot water	Boiler or heating is turned off	If you do not get water or the water is not hot, the boiler or heater may not be on. Make sure the plug of the boiler is in a working socket. Then check that both switches at the front of the boiler are on.
	You have just drawn a large quantity of hot water	A boiler can only supply up to a maximum quantity of water continuously. Wait for a short while until more hot water is available.
Water not sparkling or only a little	CO <sub>2</sub> flask empty	Is the water not sparkling enough? Is the pressure regulator below 3.5 bar? Replace your CO <sub>2</sub> cylinder. See the chapter 'Usage and maintenance' for full details on how to do this yourself.
	Water too warm	If the water is too warm, production of sparkling water becomes more difficult. Make sure that the cooler is set cold enough.
Flow irregular or sputtering	Scale buildup on the tap strainer	Clean your tap strainer. See the chapter 'Usage and maintenance' for full details on how to do this yourself.
Sparkling water sputtering or irregular	Air in the tubing	Vent your appliance: Shut off the water supply. Draw sparkling water until gas is sputtering. Switch the water supply back on. Wait an hour (cooling) before testing the result.
CO <sub>2</sub> cylinder emptying too fast	CO <sub>2</sub> cylinder not screwed on properly	The CO <sub>2</sub> cylinder must be screwed firmly onto its pressure regulator. See the chapter 'Usage and maintenance' for full details about how to screw your CO <sub>2</sub> cylinder into place.
	Cabinet space too hot	If your cabinet gets overheated, the CO <sub>2</sub> will escape through the safety vent so that the pressure in the flask doesn't become too high. Contact AQUALEX.
Water leak		Shut off the water supply and contact AQUALEX.

If the FAQ does not provide a solution, you can contact us with your problem via the MyAQUALEX platform.

This can be done via the following web address: [my.aqualex.eu](https://my.aqualex.eu)

Under 'My devices' you can select the device where a problem is occurring.

Click on 'Report problem' and follow further instructions.

If you **do not have** an account on the MyAQUALEX platform, you can contact us at the following e-mail address: [info@aqualex.eu](mailto:info@aqualex.eu)

# TERMS AND CONDITIONS

## Art. 1 Application scope:

These general terms and conditions apply to all offers, sales and rental agreements and deliveries from, with and by AQUALEX, unless expressly agreed otherwise in writing. No deviations from these general terms and conditions may be permitted, unless expressly agreed otherwise in writing. Any general terms and conditions of the client are expressly excluded. The mere fact of acceptance of an offer, the conclusion of a sales or rental agreement or the receipt of a delivery implies the acceptance by the client of the application of these general conditions.

## Art. 2 Offers, sale and rental agreements:

Offers, contracts of sale and rental agreements as well as all other commitments entered into by AQUALEX are only binding if they contain the signature or written approval of a person who can validly represent AQUALEX.

### *Offers:*

Offers are only valid until the date stated on the offer. After the expiry of the period of validity, the provisions of the quotation in question may only be accepted with the express written consent of a person legally representing AQUALEX.

All offers and quotes by AQUALEX are non-binding until accepted by the client. The contract is concluded when the client signs the offer or order form without modification and returns it to AQUALEX. Each order or order confirmation by the client, binds the client. The contract replaces all previously concluded and/or verbal agreements. The order is executed upon receipt of the advance payment.

### *Rental agreements:*

Rental agreements are effective from the date of delivery or installation for a fixed period of 60 months. They are tacitly renewed for the same period of 60 months unless one of the parties terminates the agreement by registered letter with a notice period of 6 months. The aforementioned duration and terms of notice apply unless expressly agreed otherwise in writing.

If the contract is terminated prematurely due to the fault of the client, AQUALEX reserves the right to charge a termination fee consisting on the one hand of the sum of the sums due (rental prices, maintenance prices, etc.) which, should the contract not have been terminated, would have been payable from the day of termination until the end of the contract and on the other hand of EUR 500 per hired device.

### *Cancellation:*

In case the client cancels an order, for which no advance payment has been made, the latter will be liable to pay AQUALEX damages of 30% on the full price of the goods and services ordered. If greater damages are proven by AQUALEX, the compensation claimed may be higher. If the client cancels an order for which a deposit has already been paid, the deposit already paid will not be refunded.

## Art. 3 Installation:

The client is required to carry out the necessary provisions as stipulated in the agreement at his expense prior to the installation of the device and any accessories. If the device is built-in, the client must provide the necessary ventilation in the cabinet and/or room where the device is installed. If the client has failed to take the above measures, AQUALEX will carry out these measures itself, at the client's expense, in accordance with the hourly rates in force at the time.

AQUALEX will install the device and any accessories at the location and address indicated by the client, the connection to the tap water (tap water only) must be carried out by the client under his responsibility. The device and any accessories cannot be removed or moved without the prior written consent of AQUALEX.

The client grants AQUALEX access to the place where the device and its accessories, if any, are to be installed, as well as when maintenance or repairs are to be carried out.

The stated installation times are merely approximate. Any delay in delivery shall not give rise to any indemnity on the part of the client or to the cancellation of the contract by operation of law.

## Art. 4 Device and its accessories:

The client acknowledges to have been informed of the characteristics and conditions of use of the device as well as of any accessories such as a CO-2 bottle. The client acknowledges and accepts that only CO-2 bottles supplied by AQUALEX may be used in the device.

The client undertakes:

- not to use the device and its accessories, if any, for purposes other than those for which they are intended;
- to use the device and any accessories with due care;
- to use the device and any accessories in accordance with AQUALEX's instructions, the device and its accessories, if any, shall be:
  - maintained; cleaning the drip tray, cap, drain,...
  - at taps, cleaning the tap point,...
  - kept clean and hygienic;
  - protected from sunlight, other sources of heat and dust;
  - kept indoors;
  - regularly checked for its proper functioning by means of the parameters provided for that purpose in order to prevent unnecessary damage. If necessary, the client informs AQUALEX immediately. In case of rental or purchase, AQUALEX will under no circumstances accept any damage caused by lime. Damage caused by lime is never included in the maintenance.

If a repair or replacement of the device and its accessories, if any, proves necessary due to negligence or misuse by the client, the client shall be responsible for this and shall be liable for all repair and replacement costs arising therefrom. The client is not permitted to make any modifications and/or repairs to the device or to have them made, and the client exclusively designates AQUALEX for this purpose.

If the device and any accessories are purchased, they remain the property of AQUALEX until full payment of the corresponding invoice amount. When the device is purchased, a warranty of 2 years applies from the date of purchase unless the client does not wish to purchase any maintenance. This guarantee does not cover working hours and transport costs.

If the device and its accessories, if any, are rented, the client undertakes not to sell, sublet, pledge or transfer them and always to make it clear to third parties, if necessary, that the device is not his property. Furthermore, at the termination of the rental agreement, whatever the cause of the termination of the agreement, the client must return the device and any accessories to AQUALEX in the same condition in which they were received, with the exception of normal wear and tear. To this end, the client acknowledges having examined the device and any accessories and found them to be in perfect condition.

If the device is equipped with an accessory CO-2 bottle, the client will be granted a right of use until the agreement with AQUALEX has been concluded. The client must pay a one-time fee, the price of which is determined by agreement, within 10 days of Aqualex' request to do so. This one-time payment cannot under any circumstances be regarded as an advance payment or guarantee as described in article 7 of these general terms and conditions; it is AQUALEX's responsibility even if the right of use ends. Furthermore, the client cannot claim any right of ownership on this CO-2 bottle.

**Art. 5 Risk transfer:**

As soon as and as long as the device and its accessories, if any, are in the possession of the client, he bears the risk of theft, loss or damage. In case of theft, loss or damage, the client shall immediately inform AQUALEX. The client is responsible for any damage suffered by AQUALEX.

**Art. 6 Prices and charges:**

All prices mentioned are excluding VAT, unless explicitly stated otherwise.

Rental prices are indexed annually in function of the consumer price index according to the formula:  

$$(\text{base rental price} \times \text{new index figure}) / \text{Initial index figure}$$

- The base rental price is the agreed rental price.
- The new index is the index for the month preceding the anniversary of the entry into force of the relevant agreement.
- The initial index figure is the index figure of the month preceding the month in which the relevant contract was concluded.

Maintenance prices are determined by agreement or via the order form and are also indexed annually in accordance with the above mentioned form.

The client is responsible for the electricity and water consumption as well as for all possible taxes and other charges that may be levied on the device.

AQUALEX reserves the right to change its prices. The client is entitled to terminate the contract within 8 calendar days of being informed of the price change.

**Art. 7 Advance payment and warranties:**

AQUALEX reserves the right to ask for an advance and/or a warranty with regard to the services to be provided by it.

For private persons: Unless explicitly stated otherwise in writing in the agreement, an advance invoice amounting to 50% of the full order will be issued for the private individual after each order. The balance will be invoiced after delivery or installation.

The client undertakes to pay the deposit and/or guarantee within 10 days of AQUALEX's request.

Neither the advance payment nor the warranty give rise to any interest on the part of the client.

The advance payment is considered to be a prior partial payment of the invoice amount due. The guarantee is considered to be a payment of a sum of money as security for the fulfilment of all obligations by the client, in the absence of which this warranty may be charged ipso jure and without prior notice of default against the amount owed by the client.

In case of non-payment of the advance by the private person within 30 days after receipt of the advance invoice, the supplier shall be entitled to cancel the order, whereby the above mentioned compensation shall be claimed.

**Art. 8 Invoicing:**

All AQUALEX invoices are payable, without discount, within 30 days of the invoice date, unless expressly agreed otherwise in writing.

In the event of non-payment of an invoice within the set time period, as from the due date and without prior notice of default, late-payment interest of 8% on an annual basis shall be payable, as well as a fixed compensation of EUR 40, to be increased by proven costs of collection.

In the event of non-payment on the due date and after notice of default, each amount due shall be increased, ipso jure, by 15% of the invoice amount still due, with a minimum of EUR 50, notwithstanding AQUALEX's right to claim a higher compensation, subject to proof of higher damage actually suffered.

In the event of late payment of an invoice, all invoices not yet due will become payable by operation of law and without prior notice of default.

Reminder fees may be charged.

Invoice objections must be sent to AQUALEX by registered letter within 15 days of the invoice date.

**Art. 9 Liability:**

Under no circumstances can AQUALEX be held liable, unless due to intentional fault. AQUALEX as such is not liable for any form of damage.

AQUALEX cannot be held liable for any damage caused by the water coming from the water pipe, nor for the quality of that water.

In any case, AQUALEX's liability is limited to the amounts invoiced and effectively paid to the client.

**Art. 10 Applicable law and competent courts.**

Belgian law is applicable. Only the courts of Kortrijk are competent.